

# Cam Unit - PCU-CS-15-70-(00-40)

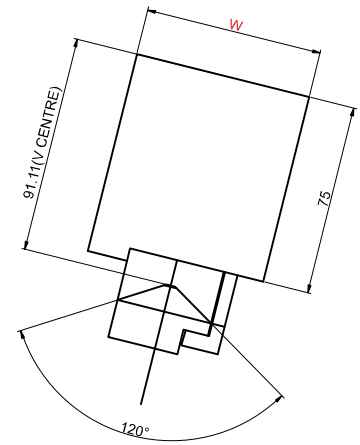

Z-View

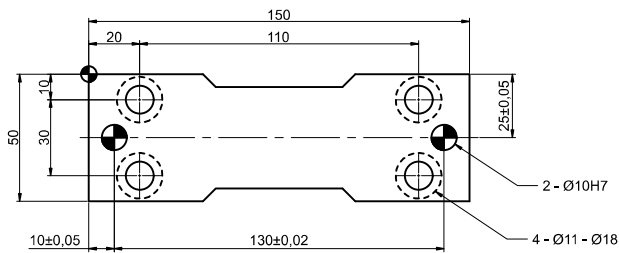
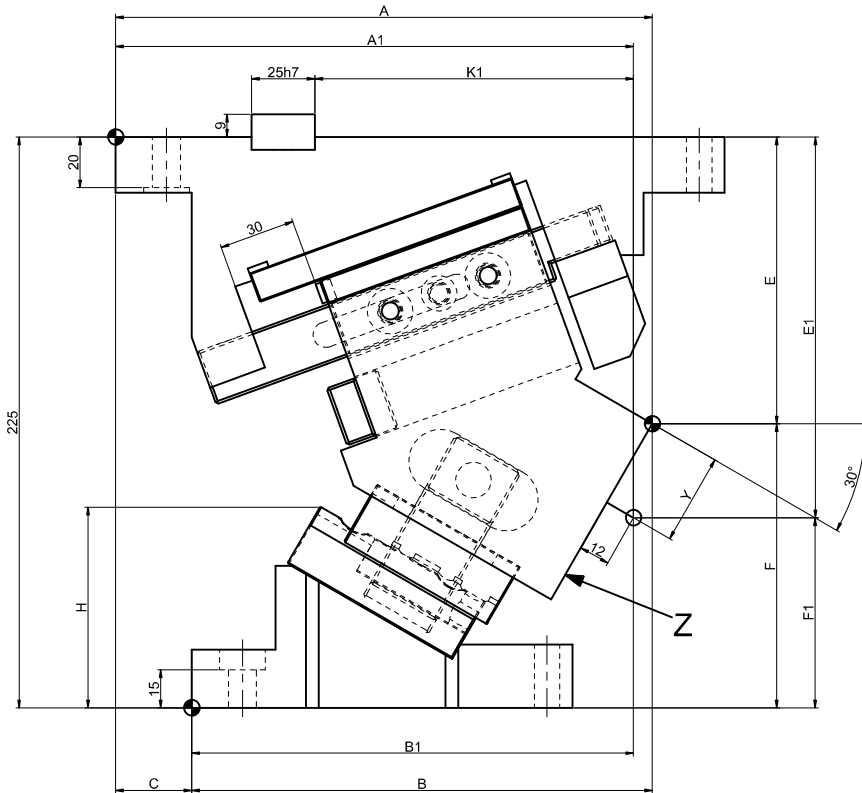
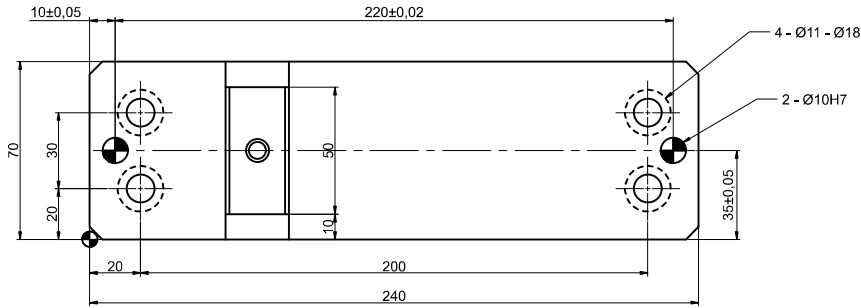
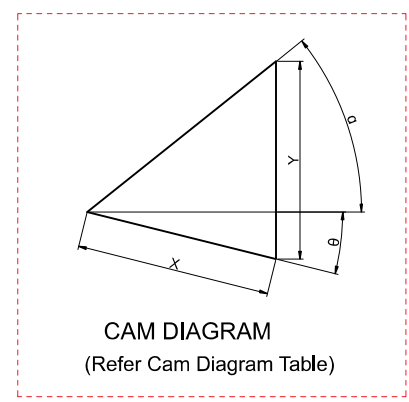

CAM DIAGRAM  
(Refer Cam Diagram Table)

## ► Cam Unit - PCU-CS-15-70-(00-40)

Cam Dimensions														Cam Diagram		
W	$\theta$	A	A1	B	B1	C	E	E1	F	F1	H	K1	y	X	Y	$\alpha$
70	00°	237.37	249.37	135.37	147.37	102	85	120	140	105	46.4	155.5	35	19.3	22.9	50°
	05°	234.87	243.53	142.87	151.53	92	86.28	125	138.72	100	53.9	149.5	37.82	21.3	23.1	45°
	10°	232.82	237.74	151.82	156.74	81	88.76	130	136.24	95	60.9	145	39.76	23.3	23.3	40°
	15°	217.54	219.67	160.54	162.67	57	96.59	135	128.41	90	63.1	140.5	36.55	25.4	23.8	35°
	20°	224.52	222.62	172.52	170.62	52	99.67	140	125.33	85	70.5	134.5	38.55	27.6	24.5	30°
	25°	223.46	218.26	181.46	176.26	42	105.45	145	119.55	80	75.7	130	38.04	30	25.4	25°
	30°	211.54	204.03	181.54	174.03	30	112.99	150	112.01	75	79.4	125.5	35.81	32.6	26.5	20°
	35°	210.68	198.86	193.68	181.86	17	117.2	155	107.8	70	86.8	119.5	37.74	35.4	28.1	15°
	40°	204.84	191.19	200.84	187.19	4	125.07	160	99.93	65	90.6	115	35.53	38.6	30	10°

Spring Force						
Slide Stroke S	Working force KN (tonf)	Total weight kg	Catalog Code	W	$\theta$	Spring Code
19.3	98.1(10.0)	16.1	PCU-CS15	70	00°	GK ISO NGK NISO
21.3		15.4			05°	
23.3		14.8			10°	
25.4		14.1			15°	
27.6		14.1			20°	
30.0		14.0			25°	
32.6		13.8			30°	
35.4		13.7			35°	
38.6		13.8			40°	

Spring type						
Spring Code	Spring specification	Spring load N (kgf)				Remarks
		$\theta$	Preload	5mm before bottom dead center	Max. load	
GK	M150-38.1	—	—	—	2350(240.0)	Gas Spring
ISO	$\phi$ 25x115	0	69(7.0)	504(51.4)	657(67.0)	Coil Spring (Constant=19.6 N/mm)
		5		519(53.0)		
		10		531(54.2)		
		15		541(55.2)		
		20		551(56.2)		
		25		559(57.0)		
		30		566(57.8)		
		35		574(58.6)		
40	580(59.2)					
NGK	—	—	—	—	—	Without gas Spring
NISO	—	—	—	—	—	Without gas Spring

Order Type:- CODE-SIZE(W)- $\theta$

Example:- PCU-CS15-70-00

Alternations-	
Option Code (OC)	Specifications
NF	Nitrogen gas not charged.

Order Type:- CODE-SIZE(W)- $\theta$ -OC

Example:- PCU-CS15-70-00-NF