

► Cam Unit - PCU-CS2-65-(50-70)

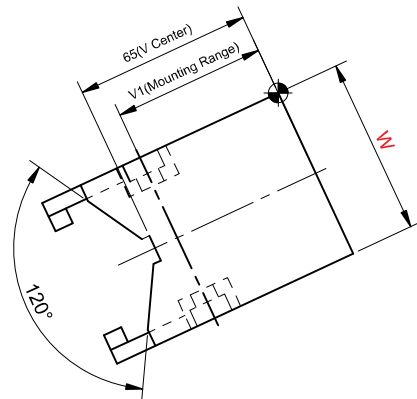
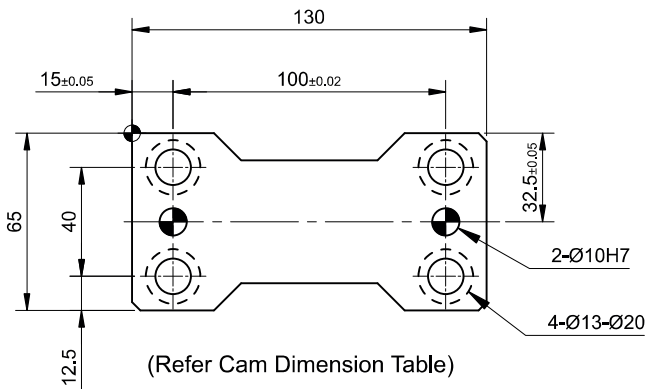
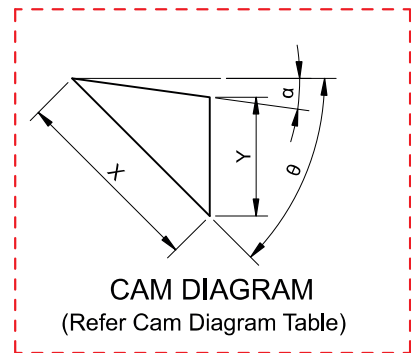
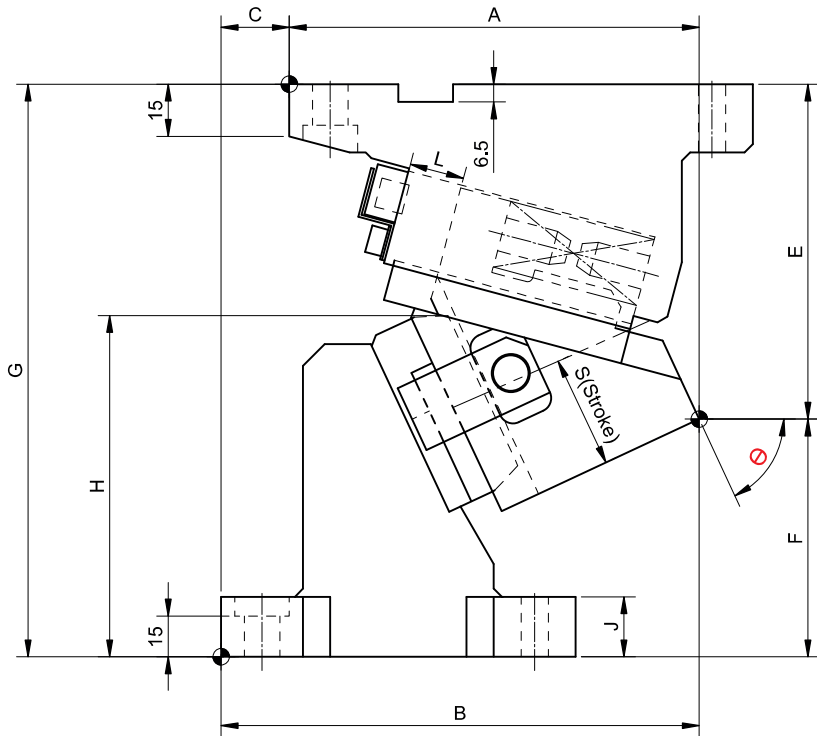
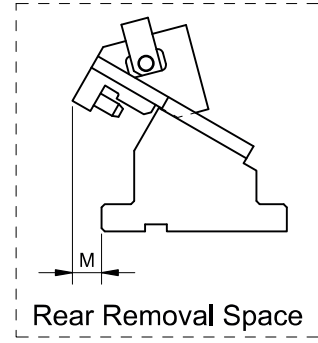
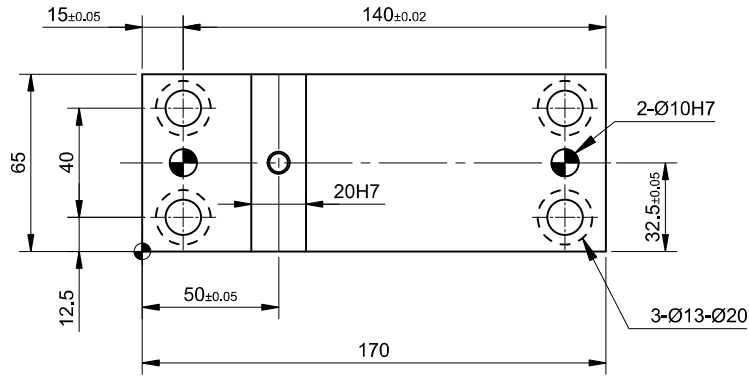

► Cam Unit - PCU-CS2-65-(50-70)

Cam Dimension													Cam Diagram		
W	Θ	A	B	C	E	F	G	H	J	L	V1	M	X	Y	α
65	50°	165.41	170.41	5	96.79	93.21	190	111.1	22	17.1	65	37	26.5	18.8	5°
	55°	159.51	169.51	10	99.89	90.11		115.3				42	29.7	22.8	
	60°	156.68	176.68	20	120.78	89.22	210	129.1	18.1	63	55	46	35	25.6	15°
	65°	150.33	175.33	25	122.80	87.2		129.4				52	41.4	32.8	
	70°	146.45	178.45	32	131.68	78.32		128.5				51.1	43.4		

Spring Force									
Slide stroke S	Working force KN (tonf)		Spring load N (kgf)			Total weight kg	Catalog No.	W	Θ
	Standard Working force	Max. working force	Preload	5mm before bottom dead center	Max. load				
26.5	19.6(2.0)	39.2(4.0)	407(41.5)	1073(109.4)	1226(125.0)	8.4	PCU-CS2	65	50°
29.7				1087(110.9)		8.4			55°
35.0		359(36.6)		1102(112.3)		9.3			60°
41.4				1121(114.3)		9.3			65°
51.1				1140(116.2)		9.5			70°

Order Type - Code-Size(W)- Θ

Example - PCU-CS2-65-50



Alternations-

Option Code(OC)	Specifications
K	Dedicated key is Attached. (it is not assembled to the main unit)
SC	The mount surface is extended forward in the range of 1 to 60 mm (in the increments of 1 mm)

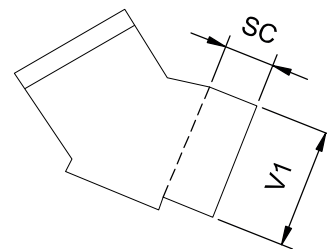

SC

Order Type:- Code-Size(W)- Θ -OC

Example:- PCU-CS2-65-50-K