

Cam Unit - PCU-CS2-80-(00-55)

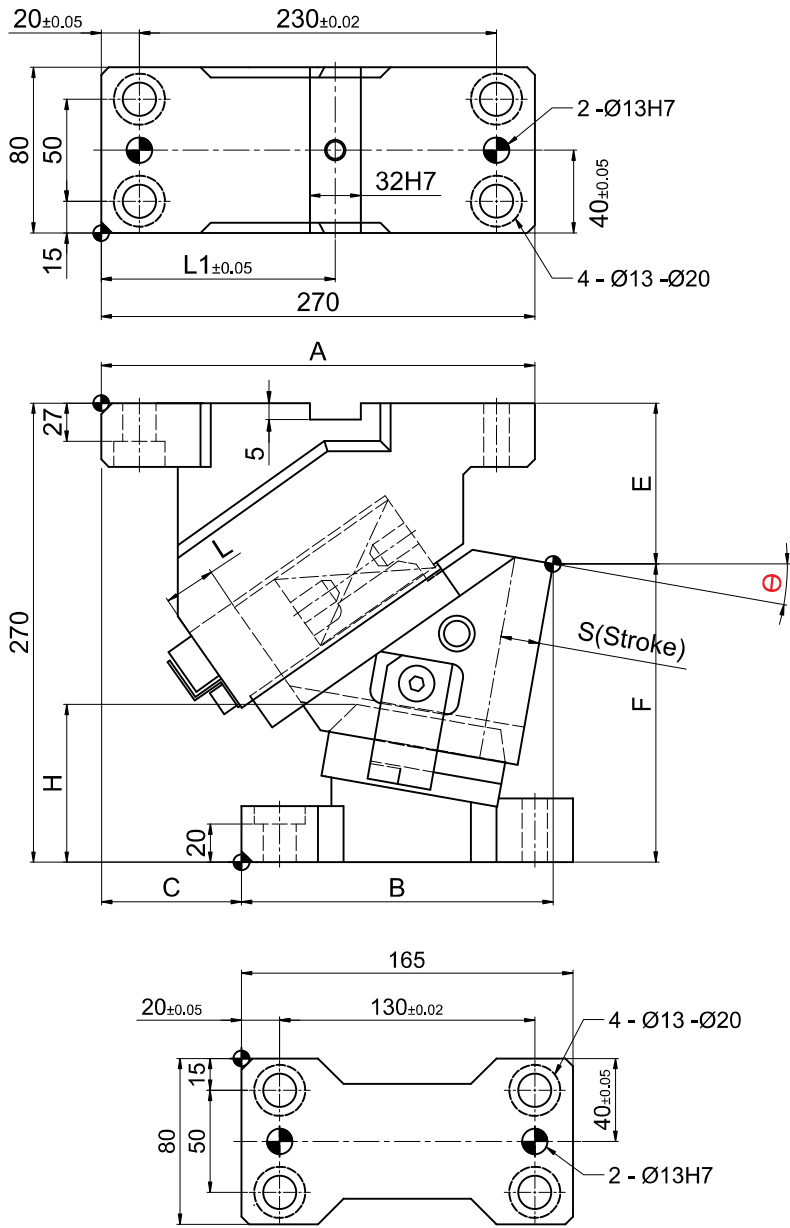

(Refer Cam Dimension Table)

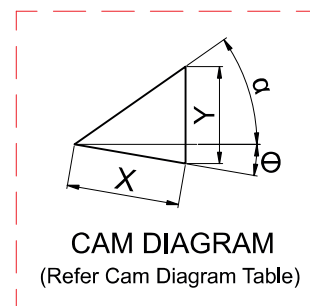
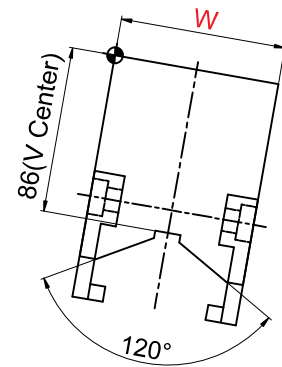
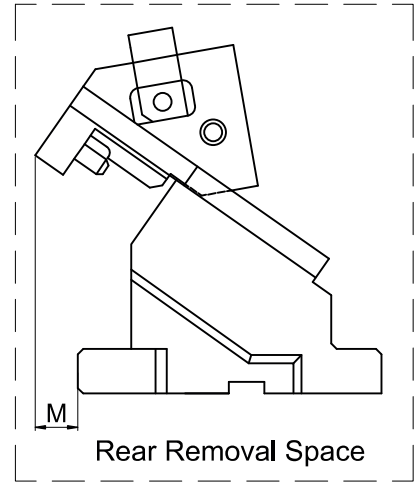

► Cam Unit - PCU-CS2-80-(00-55)

Cam Dimension										Cam Diagram			
W	Θ	A	B	C	E	F	H	L	L1	M	X	Y	α
80	00°	260.00	160.00	100	99.00	171.00	83.0	50	130	12	32.1	38.3	50°
	05°	272.93	172.93		109.39	160.61	83.8		150	17	38.4	35.5	40°
	10°	279.92	179.92		120.43	149.57	84.6				38.9	38.9	
	15°	285.93	185.93		132.04	137.96	85.3				39.7	42.4	
	20°	285.90	195.9	90	129.12	140.88	100.9				27	46.1	
	25°	289.80	199.8		141.60	128.4	101.5		47.8	45.2			
	30°	282.59	207.59	75	134.36	135.64	121.9		170	36	54.3	44.2	20°
	35°	284.27	209.27		147.32	122.68	122.3				57.4	50	
	40°	274.80	214.8	60	140.38	129.62	142.6			45	64.3	50	10°
	45°	274.20	214.2		153.44	116.56	142.7				69.6	57.9	
	50°	262.46	227.46	35	151.39	118.61	157.8		57	77.8	59.6	0°	
	55°	259.60	224.6		164.14	105.86				87.2	71.4		

Spring Force									
Slide stroke S	Working force KN (tonf)		Spring load N (kgf)			Total weight kg	Catalog No.	W	Θ
	Standard Working force	Max. working force	Preload	5mm before bottom dead center	Max. load				
32.1	39.2(4.0)	78.5(8.0)	270(27.5)	1409(143.7)	1620(165.2)	25.9	PCU-CS2	80	00°
38.4				1445(147.3)		26.3			05°
38.9				1447(147.6)		26.6			10°
39.7				1450(147.8)		25.1			15°
46.1				1474(150.3)		25.3			20°
47.8				1480(150.9)		25.3			25°
54.3				1496(152.5)		23.2			30°
57.4				1501(153.1)		23.4			35°
64.3				1515(154.5)		22.4			40°
69.6				1523(155.3)		22.4			45°
77.8				1534(156.4)		21.6			50°
87.2				1542(157.2)		21.7			55°

Order Type - Code-Size(W)-Θ

Example - PCU-CS2-80-50



Alternations-

Option Code(OC)	Specifications
K	Dedicated key is Attached. (it is not assembled to the main unit)
N16	The Dowel Pin holes for the cam holder and cam driver are changed to ø16H7
SC	Mount surface is extended forward in the range of 0 to 60 mm (in the increments of 1 mm)
WC	Mount width is changed to 100 or 120, WC100 or WC120 to be ordered.

Order Type:- Code-Size(W)-Θ-OC

Example:- PCU-CS2-80-50-K

