

► Cam Unit - PCU-CS4-400-(50-60)

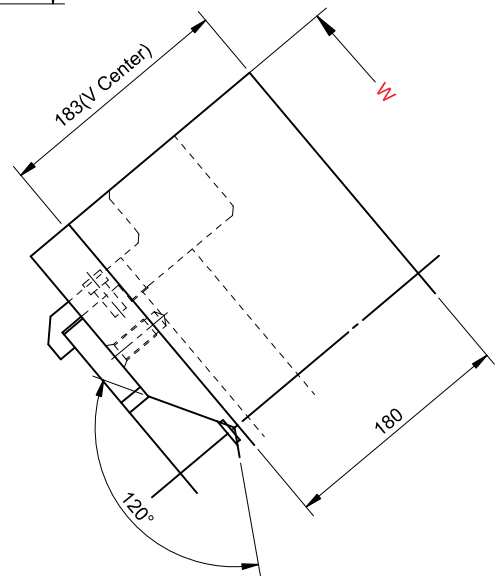
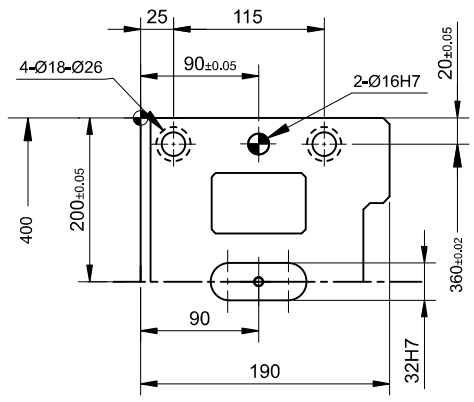
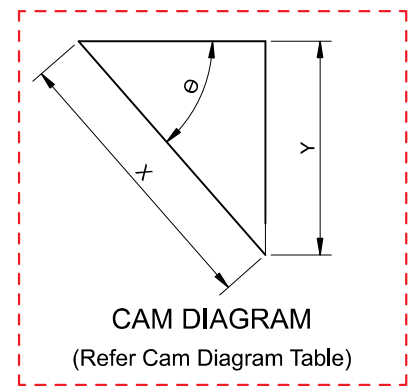
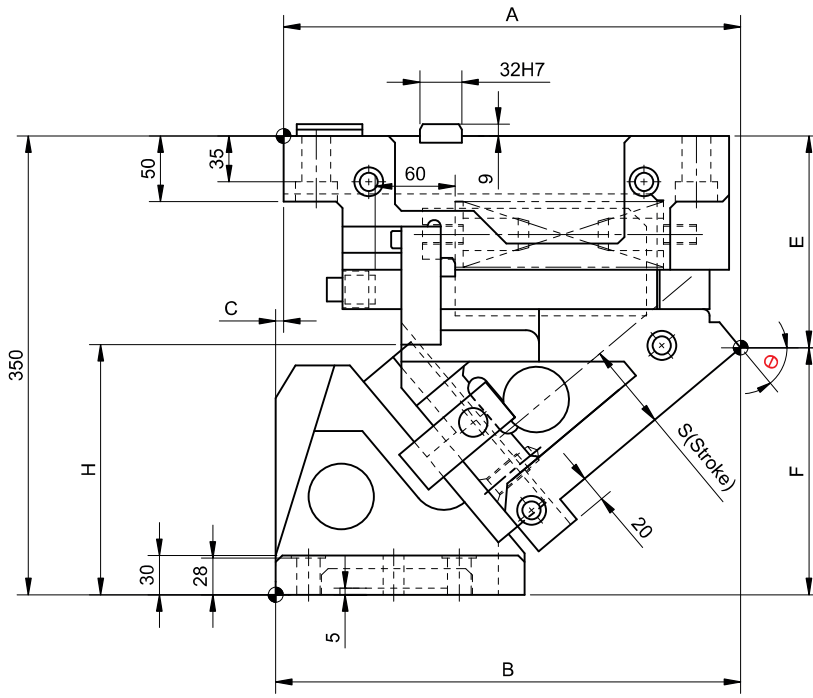
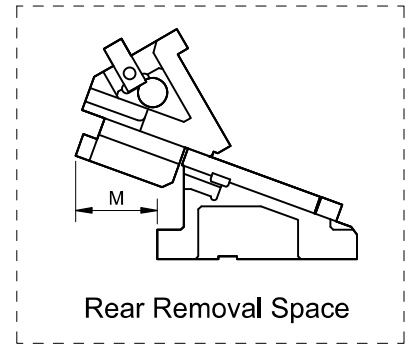
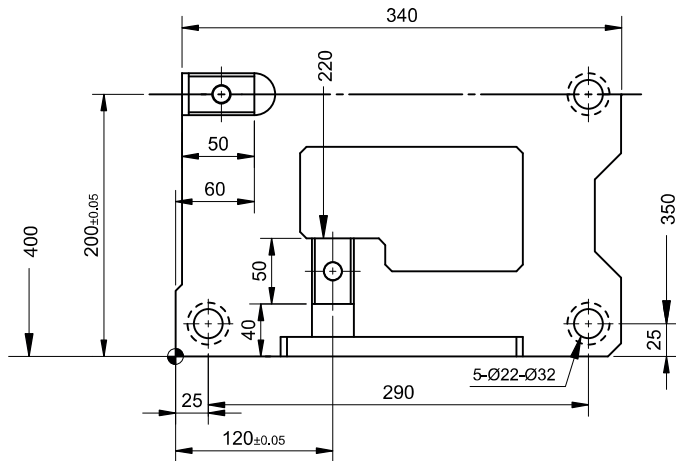

(Refer Cam Dimension Table)

► Cam Unit - PCU-CS4-400-(50-60)

Cam Dimension									Cam Diagram		
W	θ	A	B	C	E	F	H	M	X	Y	α
400	50°	348.77	354.77	6	161.49	188.51	192.8	126	93.3	71.5	0°
	60°	332.75	377.75	45	195.83	154.17	202.1	152	120	103.9	

Spring Force									
Slide Stroke S	Working force KN (tonf)		Spring load N (kgf)			Total weight kg	Catalog code	W	θ
	Standard working force	Max. working force	Preload	5mm before bottom dead center	Max. load				
93.3	245.2(25.0)	490.3(50.0)	1634(166.7)	9371(955.5)	9806(1000.0)	191.8	PCU-CS4	400	50°
120.0				9466(965.3)		201.1			60°

Order Type - Code-Size(W)- θ

Example - PCU-CS4-400-50



Alternations-

Option Code(OC)	Specifications
K	A key for driver is attached.(It is not assembled to the main unit)
N	Add Dowel Hole 2- ϕ 16 H7 Dowel Holes On Cam Holder
FK	Move Key Position Move Forward The Locating Key On Cam Holder
GS	CAM With Gas Spring. NFS-S1-750-63

Order Type:- Code-Size(W)- θ -OC

Example:- PCU-CS4-400-50-N

Option Part of N & FK

- Gas Spring Specifications Cannot do FK setting.

