

▶ UPPER PLATE (PCU-CA20)B,S,C

L=160 - 180

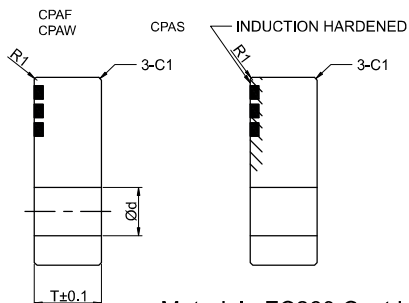
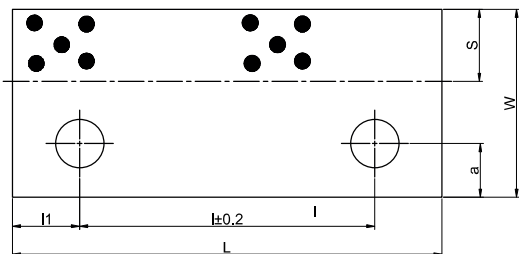

Material : FC260 Cast iron Special solid lubricant (embedded)
 Order Type : PCU-CA20-W-L-Type
 Example : PCU-CA20-70-160-C

L=200 - 240

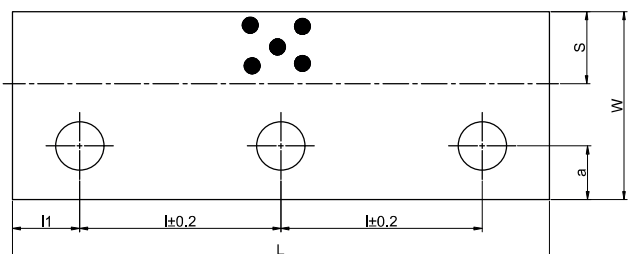

Material : EN8 Special solid lubricant (embedded)
 Hardness : 40HRC~(Induction hardened)
 Order Type : PCU-CA20-W-L-Type
 Example : PCU-CA20-70-160-S

Material : Copper alloy Special solid lubricant (embedded)
 Order Type : PCU-CA20-W-L-Type
 Example : PCU-CA20-70-160-B

L=300 - 350

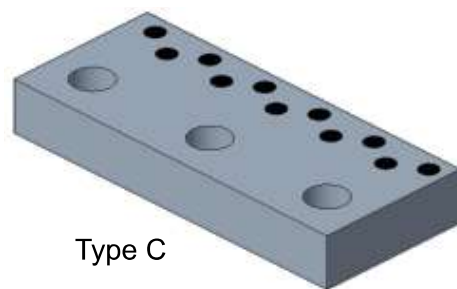
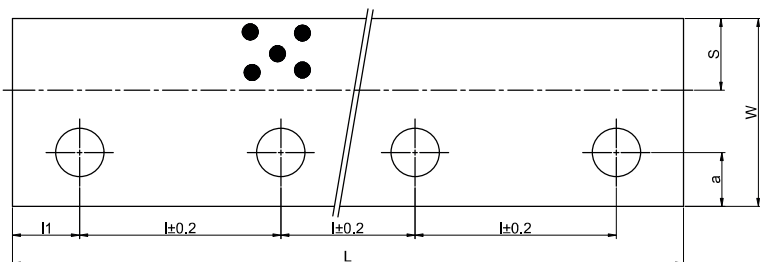

Type C

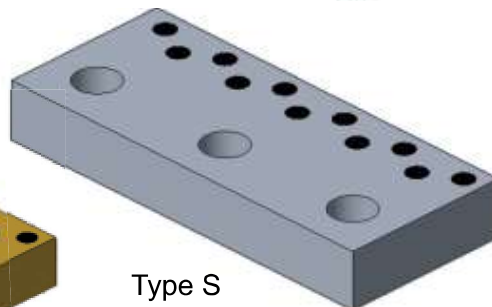

Type S

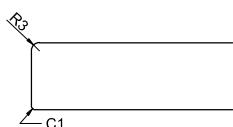

(R chamfering in L direction)

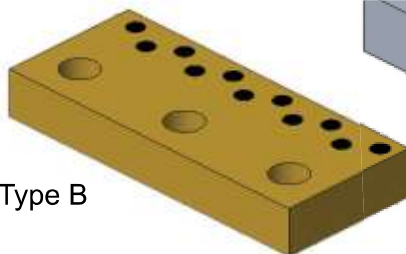

Type B

l	l1	a	s	d	T	Catalog No.	W	L	
120	30	17.5	24	18	25	PCU-CA20-C	55	180	
110	25	20	25			PCU-CA20 -C/B/S		70	160
75			200						
90	30	240							
75	25	25	30	22	28		85		200
90	30					240			
80	40					300			
90	25					350			
75	25	30				100	200		
90	30						240		
80	40						300		
90	30						350		